

Borescope Report Builder

Image Extraction and Report Generation Software



Important notes regarding folder / directory structure

ViewTech's Borescope Report Builder is a Windows-based program that easily facilitates the creation of a Microsoft Word document containing the saved images from a borescope inspection. In order to get the most out of this report builder, it is important that the inspection images are saved in a well thought out and logical folder and subfolder structure (aka "parent folder" and "child folder" or "directory" and "subdirectory").

Image folder names and directories can be created and renamed using the VJ-4 user interface. Alternatively, it may be easier to create your desired folder (and subfolder) structure on a computer, transfer this folder structure to the VJ-4 SD card, then insert the SD card into the SD card slot located on the side of your VJ-4 base unit display monitor.

This program can accommodate any number of parent folder directories, each up to three levels deep. The folders and subfolders you create will be presented in the report as corresponding to:

1. Section = Top level folder (parent folder images).
2. Area = Subfolder (child folder images).
3. Component = Sub-subfolder (2nd level child folder images).

A sample folder directory structure is presented below. In this example, all folders and images on the SD card should be transferred from the SD card to your computer and into the folder named "VJ-4 Inspection Images" (aka "Master Folder"). This Master Folder is the folder that will be selected in Step 4, outlined below.

Note that images can be saved in any or all of the folders you create, not just the bottom level folders.

SAMPLE FOLDER STRUCTURE

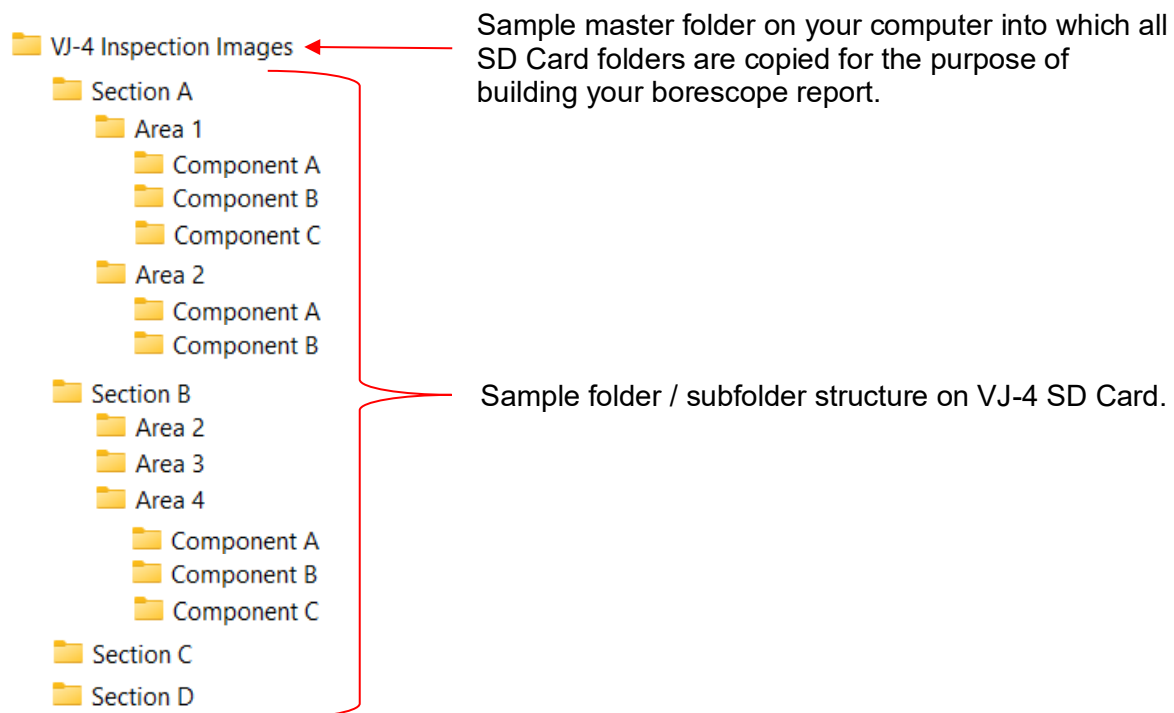

Step 1

Download the Borescope Report Maker program using the link below:

<https://ballastacademic.com/borescope/publish.html>

ViewTech Borescope Report Maker

Name: Borescope Report Maker

Version: 1.6.0.22

Publisher: ViewTech

The following prerequisites are required:

If these components are already installed, you can [launch](#) the application now. Otherwise, click the button below to install the prerequisites and run the application.

Install

Hit the Install button, as shown above and below:

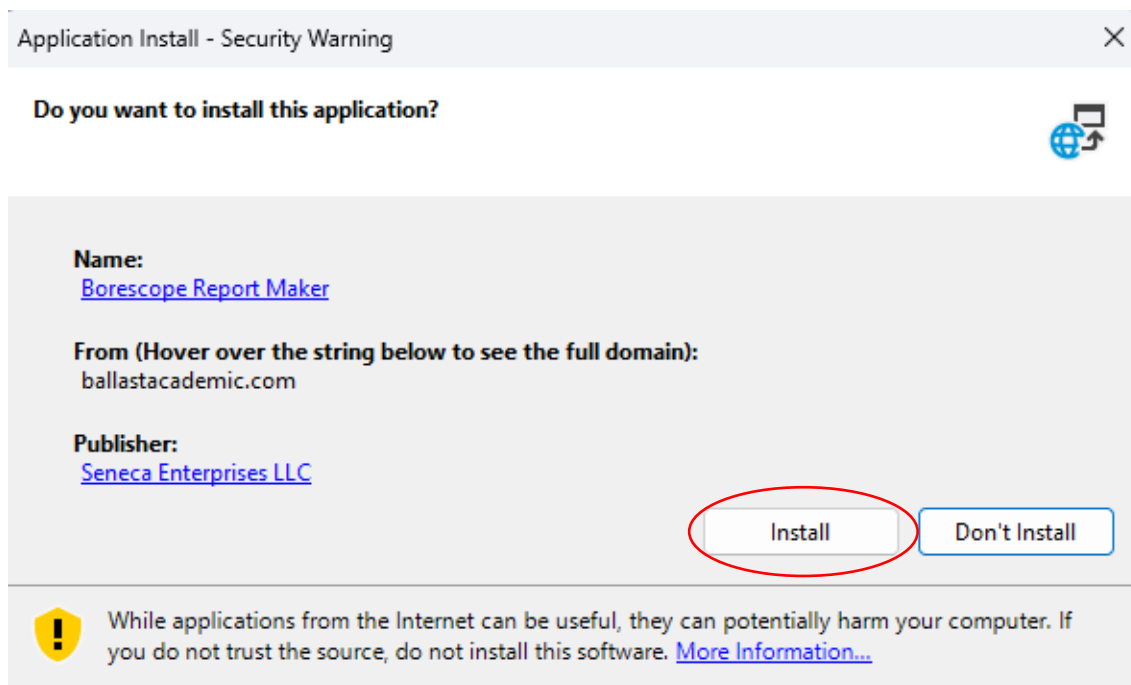

The first time you open the program, you will be prompted to enter your unique Product License Key. This is the 37-character Product Key that was provided to you by ViewTech when you purchased your software license. This Key permits the software to be loaded onto one device and is non-transferable.

Copy and paste the 37-character Product Key into the space provided. You will not need to enter this product key again after you have done so the first time using the program.

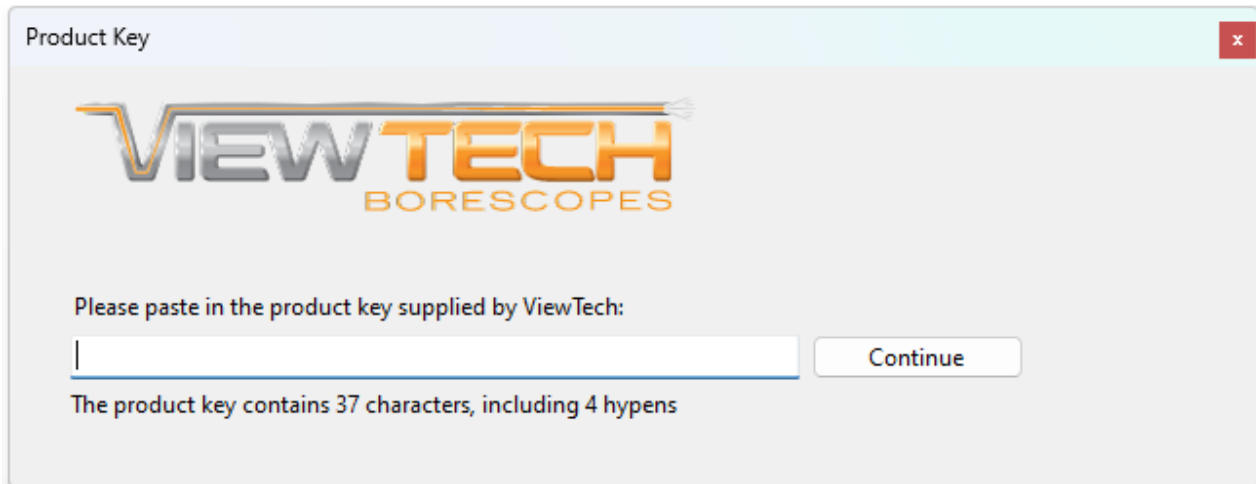
A screenshot of a software dialog box titled "Product Key". At the top is the ViewTech Borescopes logo. Below the logo, the text reads "Please paste in the product key supplied by ViewTech:". There is a text input field with a cursor inside, and a "Continue" button to its right. At the bottom, a note states "The product key contains 37 characters, including 4 hypens".

Product Key

VIEWTECH
BORESCOPES

Please paste in the product key supplied by ViewTech:

Continue

The product key contains 37 characters, including 4 hypens

Note: Each time you open the program, if you are connected to the internet, the software will automatically check to see if there have been any updates and, if so, you will be prompted to download the latest version. It is recommended that you update your software whenever there is a newer version available, as newer versions will often deliver new features or a bug fix.

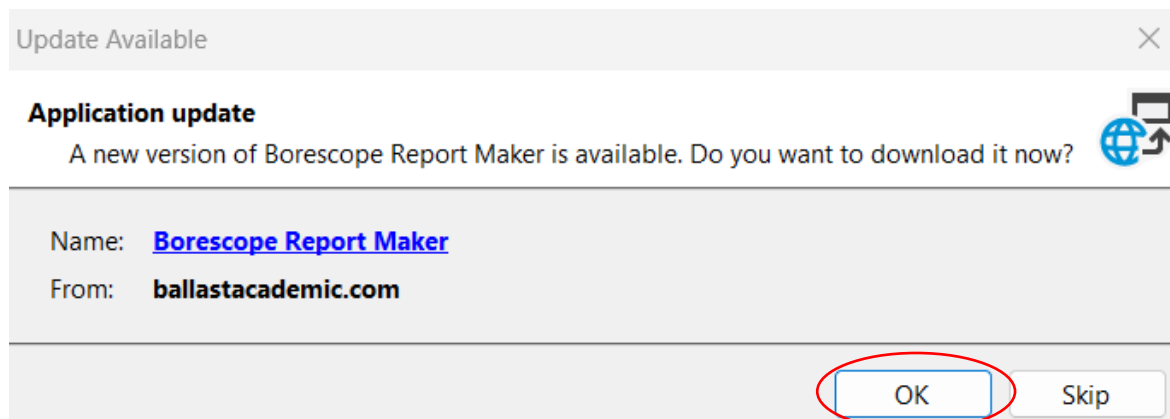
A screenshot of an "Update Available" dialog box. It has a title bar with a close button. The main text says "Application update" followed by "A new version of Borescope Report Maker is available. Do you want to download it now?". To the right is an icon of a globe with an upward arrow. Below this, it lists "Name: Borescope Report Maker" and "From: ballastacademic.com". At the bottom are "OK" and "Skip" buttons, with the "OK" button circled in red.

Update Available

Application update

A new version of Borescope Report Maker is available. Do you want to download it now?

Name: [Borescope Report Maker](#)

From: [ballastacademic.com](#)

OK Skip

Step 2

After installation, you will have a shortcut on your desktop to the ViewTech Borescope Report Builder program. Double click this shortcut to open the program.



Step 3

When you open the Borescope Report Maker software, the first screen will give you the option to:

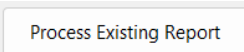
1. Generate a New Report from a folder of images. 
- or
2. Process an Existing Report that is already saved to your PC. 

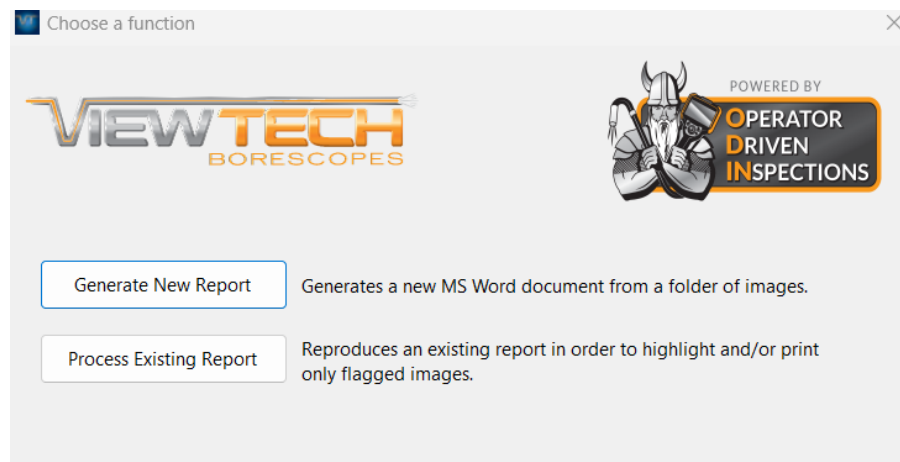

If this is the first time you are generating a report from a certain folder of images, click on the “Generate New Report” button. If you want to instead Process a report that has already been created and saved, then press the Process Existing Report button.

Note: When you Generate a New Report, you will be able to flag images in that report and insert comments where desired. Reasons you may want to flag an image include:

- To make note of defects or other areas of concern in an image.
- To point out questionable images that may require more investigation.
- To denote images showing excellent component condition or quality workmanship.
- To flag/review the status and durability of a prior repair.

After this initial report, including flagged images and comments, is saved, you have the option of Processing that Existing Report to create hyperlinks to all flagged images and, if desired, condense the report to include only the flagged images. This can be done by using the “Process Existing Report” button, as shown in Step 7.

Step 4

After pressing the **Generate New Report** button, the following screen will appear. Here you will input all the relevant information regarding the inspection and inspector. You also have the option of adding a watermark to the lower left corner of each image in your report. The watermark can be text or an image you select.

The screenshot shows the 'ViewTech: Borescope Report Builder' application window. It features a top header with the ViewTech logo and a 'POWERED BY OPERATOR DRIVEN INSPECTIONS' badge. The main area is divided into two columns: 'Inspection Details' and 'Inspector'. Below these is a 'Generate New Report' section with input fields for 'Images Folder' and 'Save Report As', a 'Found 17 folders and 49 image files' status, and buttons for 'Browse', 'Start Job', 'Process Existing Report', and 'Generate New Report'. An 'Add Watermark' dialog box is open, showing options for 'Watermark Type' (None, Image, Text) and 'Watermark Text' (Quality NDT), with settings for 'Font Size' (15) and 'Transparency' (50). Red arrows and text annotations provide guidance: 'Enter Inspection and Inspector details.' points to the input fields; 'Create watermark if desired' points to the 'Add Watermark' dialog; 'Select source folder that contains all folders and images.' points to the 'Images Folder' field; 'Press Start Job to create the report.' points to the 'Start Job' button; and 'Input name and location for the new report.' points to the 'Save Report As' field.

Inspection Details

Inspection Location: Kalkaska, MI

Inspection Subject: PT6A-42 N3697F

Engine # and/or Serial #: PCE-PJ0205

Date of Inspection: Sept 22, 2024

Time of Inspection: 9:40 am

Inspector

Inspector Name: David Sklark

Company: Quality NDT

Phone: 231-476-3345

Email: david@qualndt.com

Generate New Report

Images Folder: C:\VJ-4 Inspection Images **Browse**

Save Report As: C:\Master\Borescope Report Maker\Kalkaska PT6 Report.docx **Browse**

Found 17 folders and 49 image files

Start Job

Process Existing Report

Generate New Report

Add Watermark

Watermark Type: ☐ None ☐ Image ☒ Text

Watermark Text: Quality NDT

Font Size: 15

Transparency: 50

Save

Annotations:

- Enter Inspection and Inspector details.
- Create watermark if desired
- Select source folder that contains all folders and images.
- Press Start Job to create the report.
- Input name and location for the new report.

Step 5

Your report will open in MS Word:

Cover Page



INSPECTION DETAILS

Location: Kalkaska, MI
Inspection Subject: PT6A-42 N3697F
Engine # or Serial#: PCE-PJ0205
Date of Inspection: Sept 22, 2024
Time of Inspection: 9:40 am

INSPECTOR

Name: David ~~Skark~~
Company: Quality NDT
Phone: 231-476-3345
Email: david@qualndt.com

Inspection Summary

	Images	Flagged Images
Root Folder	4	
Gearbox Outside	3	
General	2	
Helical	2/24	
_Helical\High Speed	2	
_Helical\IMS	5	
_Helical\IMS\Sandusky12	9	
_Helical\Low Speed	6	
Inline Filtration	2	
Main Bearing	0	
Name Plate	4	
Planetary	1/10	
_Planetary\Carrier Bearing	7	
_Planetary\Planet 1	2	

Each page in the report will contain one image. You can insert comments and/or flag any image. After doing so, save the report to your computer. You can then proceed to process the flagged images into a second report, as described in Step 7.

Flag images
as necessary
by checking
this box.

Section	Helical
Area	IMS
Component	Sandusky12
Photo	20190919_184737.JPG
Comments	Input comments here.

☐ Flag Image | [Back to Summary](#)



Step 6

After you have generated an initial report, if you have flagged any images, you have the option of further processing that report in order to add hyperlinks to each flagged image and, if desired, condense the report by excluding all non-flagged images.

To process the flagged images of an existing report, return to the software and select

Process Existing Report

This will bring you to the screen below, where you can browse and navigate to an existing report.

Process Image Flags

VIEWTECH
BORESCOPIES

This feature will allow you to rebuild an existing report to include only the flagged images.

Target Report: C:\VJ-4 Inspection Images\Kalkaska PT6.docx

Browse

< Back to Menu ☐ Include flagged images only Process Image Flags

If you would like to include only flagged images in this report, check this box. Otherwise, press Process Image Flags to generate a report that contains all the images along with hyperlinks to flagged images.

Report rebuilt. Flagged images have been marked.

OK

Step 7

Your report will open in MS Word, and will now include hyperlinks to each of your flagged images. If you checked the box "Include flagged images only", all non-flagged images will be excluded from your report.

Inspection Summary Page – Flagged Images Processed with Hyperlinks

Inspection Summary

	Original Image Count	Flagged Images
Root Folder	4	01 02
Gearbox Outside	3	
General	2	09
Helical	2/24	10 11
_ Helical\High Speed	2	
_ Helical\NMS	5	15 16 18
_ Helical\NMS\Sandusky12	9	25 26 27
_ Helical\Low Speed	6	28 33
Inline Filtration	2	34
Main Bearing	0	
Name Plate	4	36 37 39
Planetary	1/10	40
_ Planetary\Carrier Bearing	7	44 45
_ Planetary\Planet 1	2	